





GREAT ROOM

AT 10,000 SQUARE FEET,
IT REALLY IS **GREAT** AND
ONE OF THE LARGEST
BALLROOMS IN THE AREA.

ALTITUDE

STUNNING VIEWS
OF THE CITY AND
PIEDMONT PARK SET
THE BACKDROP FOR OUR
27TH FLOOR BALLROOM.



PLAN WELL

LOCATION

Host your wedding or event in the heart of Midtown Atlanta, where museums, delectable dining and nightlife fuse with abundant green space and a walkable community. No driving is necessary to experience the city's best like a true local.

Surrounding the hotel are Piedmont Park, High Museum of Art, Atlanta Botanical Garden, Georgia Tech, Fabulous Fox Theatre and a number of other iconic entertainment venues. Plus, top restaurants from local burger joints to James Beard Award-winning fine dining are just steps away.

A nearby MARTA rail station quickly and easily connects the hotel to Hartsfield-Jackson International Airport and Atlanta's sports arenas.

BOASTING RIGHTS

W Atlanta - Midtown boasts 30,000 square feet of meeting and event space, one of the largest in the global W portfolio. Our professional staff of planners, engineers, chefs and service talent creates turnkey events that impress the most selective of clients, while also infusing W signature style and innovation.

GREAT ROOM

At 10,000 square feet, this room is one of the largest ballrooms in the area and can accommodate up to 1,200 guests for a reception and 500 for a seated dinner. Great Room provides the perfect palette to let your creative genius shine — the room suits everything from dance floors, stages and dramatic lighting to aerialists spinning from the ceiling to large scale installations. For an over the top event, Great Room is your choice.

ALTITUDE

Imagine glittering views of the city from our elegant 27th floor ballroom as the backdrop to your event for up to 300 people for a reception and 175 for a seated dinner. Altitude is perfect for high style, from cocktail hours to seated dinners. Add a dance floor, sofas and high-top tables for the most chic penthouse lounge in the city.

A romantic couple is seen from behind, embracing on a balcony. The woman is wearing a long, flowing, light-colored dress, and the man is in a dark suit. They are looking out over a city skyline at dusk or dawn. In the foreground, there are decorative elements: bare, dark branches on the left and some red flowers on the right. The overall mood is intimate and celebratory.

MAKE IT YOURS

MAKE OUR SPACE YOURS.
WEDDINGS. COMMITMENT
CEREMONIES. BAR AND
BAT MITZVAHS. PROMS.
BIRTHDAYS. ANNIVERSARIES
PHILANTHROPIC EVENTS —
ANY REASON TO CELEBRATE.
**WHATEVER/WHENEVER.
YOUR WISH. OUR DESIRE.**



CUSTOMIZE US

It's all about you. Your day, your style, your perfect experience. Our team is here to take you through every step from visualizing to executing.

If you have a special wish, desire or need, we're here to grant it. Tell us about your traditions, religious requirements or lavish ideas. We will accommodate. From flying acrobats to horse-drawn thrones, we do it all.

CULINARY EXPERIENCE

Allow our Executive Chef and culinary team to customize a special menu to complement your special day — from a five-course meal with wine pairings to interactive stations to themed offerings. What's your favorite meal? What's your favorite childhood snack? Give us some idea about what you like best, and we'll bring it to life. Plus, you'll enjoy a complimentary tasting prior to your event to make sure everything will be exactly how you want it.

WHATEVER/WHENEVER®

Event hosts and their out-of-town guests enjoy the brand's signature Whatever/Whenever® service promise, offering our guests whatever they want — from sought-after dining reservations to front-row seats at the hottest show in town — whenever they want it.

SPG® PRO

Event hosts, planners and overnight guests to W Hotels can earn elite status and Starpoints®, the richest points program in the travel industry, which includes St. Regis, Westin Hotels & Resorts, Sheraton Hotels & Resorts, Four Points, Le Meridien, Luxury Collection, Aloft, and Element Hotels. Learn more at spg.com/pro. Don't forget you can also earn additional Starpoints® as you travel in style with our partners — Delta Airlines and Uber.

Extend the rewards to your honeymoon — earn one Starpoint® for every three dollars at the conclusion of your event. Choose to spend your points at your dream honeymoon destination. Starwood Hotels and Resorts has over 1,100 locations worldwide.



ALL UNDER ONE ROOF



DF

PRE-EVENT.
MAIN EVENT.
POST-EVENT.
EASY.

BEFORE & AFTER

You have your main event, but that's not all. Host rehearsal dinners, day-of luncheons, day-after brunches all right here.

TRACE

For rehearsal dinners, celebratory brunches, bachelorette/bachelor parties, showers, or any other pre- or post-event, allow us to arrange it for you in TRACE, our farm-to-table take on the Southern dining experience. Choose from a variety of sizes and setups, from the intimate, private and cozy Pantry, to the bright and airy Overlook, to a complete buyout of the restaurant.

WHISKEY PARK

For a truly impressive VIP experience, ask us about reserving Whiskey Park's Vault, an ultra-exclusive room with its own private bar. This venue is perfect for your after party.

RETREAT

Host an urban garden party in Retreat, our outdoor space on the second floor that features our Chef's Herb Garden and comfortable soft seating. Consider an interactive culinary cocktail bar, where your guests can pick their favorite herbs from the garden, then allow our mixologist to whip up something custom for them.

BALLROOMS & EVENT SPACES

Of course, with Great Room, Altitude and our myriad of studios and spaces, whatever you dream up, we can create. Who says the day-before and day-after can't be as spectacular as the day-of?

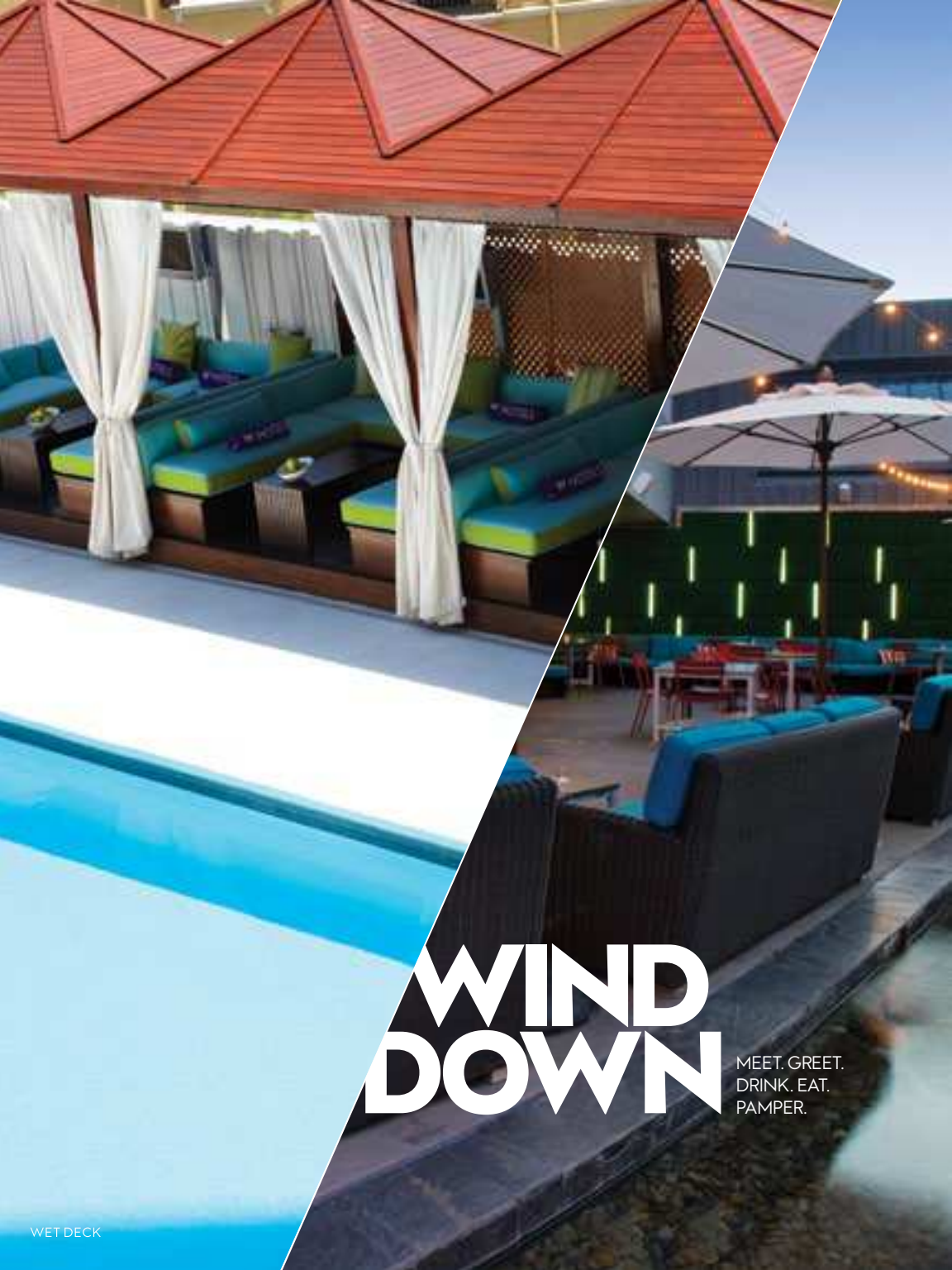

WIND DOWN

MEET. GREET.
DRINK. EAT.
PAMPER.



SPOIL YOURSELF MAKE THE MOST OF IT

Staying the weekend? You and your guests will enjoy the vibrant, stylish scene created by our amenities.

LIVING ROOM

Sip a cocktail on the patio or soak up the atmosphere in this Gerber Group lounge. Savor small plates, use complimentary Wi-Fi and mix and mingle.

TRACE

Guests don't have to leave the hotel for one of Atlanta's top dining experiences — a farm-to-hotel concept, bringing local flavors and a taste of the countryside to the city's most glam hotel. Join us for breakfast, lunch, dinner or cocktails at the bar, seven days a week.

WHISKEY PARK

Experience rising star DJs, culinary cocktails and an electric vibe in Gerber Group's Whiskey Park bar. Hang at the bar or outdoor patio, or reserve your own table for a VIP experience.

WET

Our chic outdoor pool deck is perfect for a refreshing swim, lounging in the sun, or relaxing in a private cabana.

BLISS SPA

De-stress and rejuvenate with a pampering Bliss treatment. Enjoy one of our signature facials, body treatments, mani-pedis or massages.

FIT

Energize in our FIT gym, fully equipped with everything from treadmills and ellipticals to free weights and stability balls.

27TH FLOOR



LIVING ROOM LEVEL

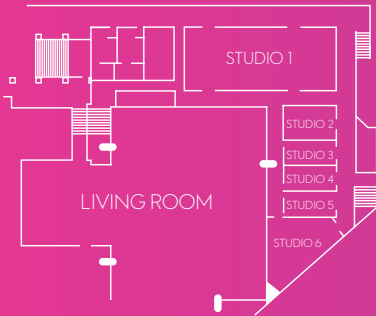

MEZZANINE LEVEL

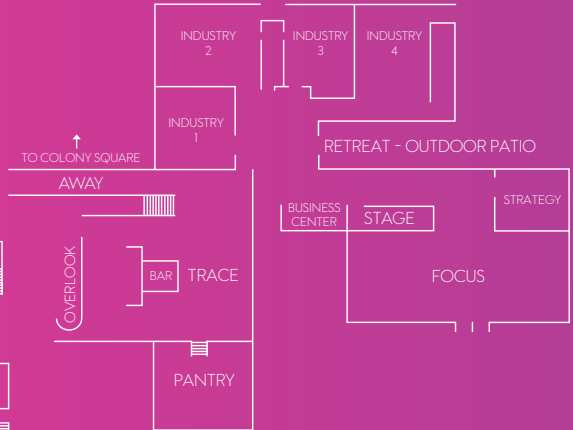

LOWER LEVEL

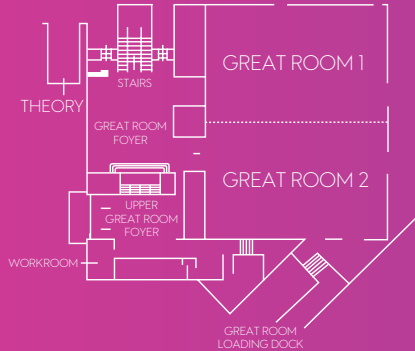

ROOMS

	DIMENSIONS	CEILING HEIGHT	SQUARE FEET	THEATRE STYLE	CLASSROOM 2.5 per / 2 per	CONFERENCE 2.5 per	HOLLOW SQUARE 2.5 per	U SHAPE 2.5 per	CRESCENT ROUNDS 6 per	RECEPTION	BANQUET 10 per
27TH FLOOR											
Altitude	71' x 54'	12'	3,774	264	144 / 108	30	56	48	96	260	160
MEZZANINE LEVEL											
Industry 1	30' x 30'	12'	900	60	40 / 32	18	26	21	24	50	40
Industry 2	37' x 31'	12'	1,147	84	50 / 40	18	26	24	36	70	60
Industry 3	34' x 27'	12'	918	60	40 / 32	18	26	21	30	50	50
Industry 4	41' x 27'	12'	1,107	80	40 / 32	18	26	30	36	70	60
Away	98' x 19'	11'	1,862	=	=	=	=	=	=	120	70
Retreat	49' x 20'	=	990	=	=	=	=	=	=	75	50
Strategy	27' x 21'	12'	567	=	=	16	=	=	=	=	=
Focus	76' x 34'	12'	2,584	210	125 / 100	48	62	54	90	200	150
Stage	28' x 10'	8'	280	=	=	6	=	=	=	=	=
TRACE	65' x 35'	=	2,275	=	=	=	=	=	=	250	150
Overlook	29' x 25'	=	725	=	=	=	=	=	=	40	38
Pantry	40' x 33'	=	1,320	=	=	=	=	=	=	90	74
LIVING ROOM LEVEL											
Studio 1	87' x 35'	12' 1"	3,045	288	115 / 92	54	62	54	96	180	160
Studio 2	22' x 20'	12'	440	50	16	12	14	15	18	30	30
Studio 3	30' x 14'	12'	420	42	16	16	20	18	12	20	20
Studio 4	30' x 14'	12'	420	42	16	16	20	18	12	20	20
Studio 5	29' x 16'	12'	464	42	16	16	20	18	12	20	20
Studio 6	36' x 44'	11'	1,085	85	42 / 34	24	24	27	42	70	70
LOWER LEVEL											
Great Room	109' x 86'	17' 10"	9,374	900	546 / 390	=	=	=	324	1,200	540
Great Room 1	54' x 86'	17' 10"	4,644	468	224 / 168	48	86	69	144	600	240
Great Room 2	54' x 86'	17' 10"	4,644	468	224 / 168	48	86	69	144	600	240
Great Room Foyer	53' x 95'	12'	3,705	=	=	=	=	=	=	200	=
Workroom	12' x 18'	12' 1"	216	=	=	=	=	=	=	=	=
Theory	26' x 14'	8'	364	=	=	12	=	=	=	=	=



**SEE
YOU
SOON**